



GlucoMen[®] areo 2K

Quick guide



NOTE! This is a quick quick guide. Detailed information you will find in the instruction manual that comes with the meter.

Here's how to measure your blood sugar/ketone value.

Time and date are preset, but make sure they are correct the first time you use the meter.

1. Wash your hands with soap and water.
2. Take a glucose or β -ketone test strip out of the jar and place immediately on the lid again.
3. Insert the end of the test strip that has a metallic contact surface, in the meter opening.
4. The meter shows a flashing blood drop and "Glu" or "Ket" in the lower left corner and is now ready for measurement.
5. Stick with the sampler.
6. Place the blood drop against the short end of the stick, which will suck up the right amount of blood. A beep sounds and a countdown starts on the screen.
7. Read test results. A beep sounds when the result is displayed on the screen. (after 5 seconds for blood sugar and 8 seconds for β -ketone sticks)
8. Press the eject button to remove the used test stick. The meter turns off automatically.

3.

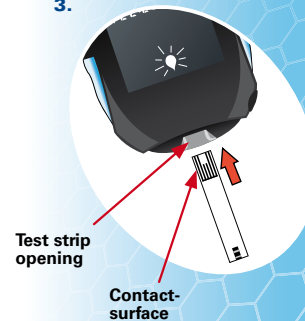

6.



Here's how you can select a metric

1. When your test result is displayed, press ⏻ until the highlight symbols starts flashing. Use the arrow buttons (\blacktriangle / \blacktriangledown) to select the desired selection ⓧ (before meal), Ⓜ (after meal), Ⓢ (exercise) or \checkmark (general).
2. Press the ⏻ button to confirm the selection. You can choose repeat several steps (but only one when you select ⓧ or Ⓜ) by repeating steps 1 and 2.

To set the time and date.

1. Make sure the meter is turned off. (If not, press ⏻ for 3 seconds).
2. Press ⏻ for 4 seconds to access the setup menu.
3. Press \blacktriangle or \blacktriangledown to scroll through the setup menus and press ⏻ to access the various menus.
4. Use \blacktriangle or \blacktriangledown to select the value. Press ⏻ to confirm and move to the next step: year, month, day, time format, hour, minutes.
5. After confirming the minutes (by pressing ⏻) you will return to the settings menu.

How to manage measurement results in memory.

Your meter saves up to 730 blood sugar values and 100 β ketone values with date, time and markings.

1. Make sure the meter is turned off. (If not, press ⏻ for 3 seconds).
2. Press ⏻ for 2 seconds to start ("mem" appears on screen and "GLU" flashes).
3. Press ⏻ to view stored blood glucose values, or scroll with \blacktriangle and \blacktriangledown to switch to stored β -ketone values. When "KET" flashes on the screen, confirm with ⏻ .
4. Press ⏻ for more than 3 seconds to turn off the meter.

View average blood glucose values for 1, 7, 14, 30, 60 or 90 days.

1. Press ⏻ for 2 seconds to turn on the meter. Press ⏻ again ("AVG" appears on the screen). The meter shows today's average.
2. Continue pressing ⏻ to display the cut for 1, 7, 14, 30, 60, or 90 days.
3. Press ⏻ for more than 3 seconds to turn off the meter.

GlucoMen[®] areo 2K

Button for On/Off/Enter

Test strip opening



\blacktriangle / \blacktriangledown
Up/Down buttons



Wireless transmission with NFC (Near Field Communication)

Your saved test results can be transferred to an NFC-equipped device (eg a smartphone) with an NFC-compatible app installed (eg GlucoLog).

For the first time, you must activate your meter's NFC function (you will find it in the setup menus) by pressing the ▲ or ▼ button to select ON or OFF. Press to confirm and leave.

1. Enable the NFC transfer in the app on your smartphone.
2. Place your meter back to back with your smartphone (<1 cm).
3. The meter starts automatically and data is transferred (N) flashes on screen).
4. When the data transfer is complete, "End" appears on the screen along with the (N) symbol, and a beep sounds.
5. Press for 3 seconds to turn off the meter.

How to replace the battery in GlucoMen® Areo 2K.

The meter is powered by two CR2032 3V batteries. When the low battery symbol is on, it's time to change. You do not have to set the date and time if you insert new batteries within 2 minutes after removing the old ones. How to use:

1. Make sure the meter is turned off.
2. Carefully remove the meter from the bag.
3. Open the battery cover on the back of the meter and remove the batteries.
4. Insert the new batteries into the battery holder with the "+" side facing up.
5. Close the battery cover by sliding it back (do not push).

GlucoMen®
areo 2K



How to use the sampler GlucoJect Dual PLUS®

1. Wash your hands or alternate sticking place. Unscrew the sampler tip by turning it counterclockwise.

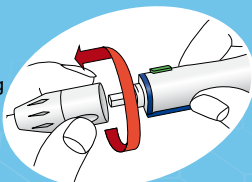

2. Insert a new sterile lancet into the lancet holder and push it fully in.

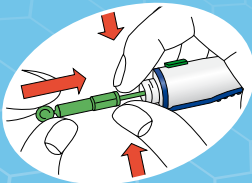

3. Set the knitting depth by turning the tip. 1-2 for soft or thin skin, 3 for normal skin, 4-5 for thick or hardened skin.

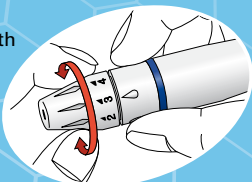

WARNING! NEVER use the sampler for more than a person. Take a new lancet for each sampling and do not leave used lancet in the sampler.

4. Pull out the sliding sleeve to load the sampler. Hold the sampler against your finger and press the shutter button.

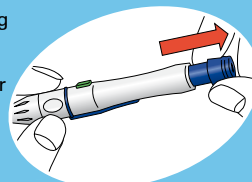

5. Push the lancet ejector forward with your thumb while pulling out the slide sleeve to discard the used lancet.

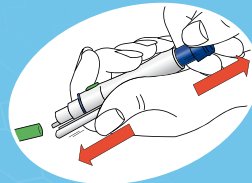

Alternative sampling point

Place the sampler on the skin on the selected knitting area. Press and hold for a few seconds, then press the shutter button to take a blood sample.

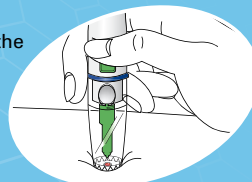

Error codes and messages

- ER 1** System failure hardware. Remove and reinsert the batteries and repeat the test with a new test strip. If the error code remains, contact customer service.
- ER 2** The test strip is damaged or used, or the blood test has been applied before the blood drop symbol started flashing on the screen. Repeat the test with a new strip.
- ER 3** The test strip received too little blood. Stick again to repeat the test with a new test strip and the right amount of blood.
- ER 4** The test strip was removed or disrupted during the countdown. Repeat the test with a new test strip.
- ER 5** NFC was disconnected during the transfer. Repeat the NFC transmission. If the problem persists, contact customer service.
- HI**
LO
Your measured blood sugar value is higher than 33.3 mmol / L!
Your measured blood sugar value is lower than 1.1 mmol / L!
- HI**
LO
(Flashing) Your measured β -ketone value is higher than 8 mmol / L!
(Blinking) No action is required. Your measured β -ketone value is lower than 0.1 mmol / L, which is normal.

WARNING! If HI or LO appears, consult your health care provider before changing your treatment. If HI or LO is shown repeatedly even though your blood glucose values are not high or low, contact customer service.

Customer service: 040-32 12 70 info@menarinidiagnostics.se

GlucoMen®
areo 2K



www.aro.nu
shop.menarinidiagnostics.se

2017-10 GlucoMen Areo 2K Quick Guide A4 - ENG